

CAPITALS OF CENTRAL EUROPE & DANUBE RIVER CRUISE

Hungary - Slovakia - Austria - Germany - Czech Republic
September 21 - October 03, 2005 (13 days)

Includes all
excursions
during cruise!

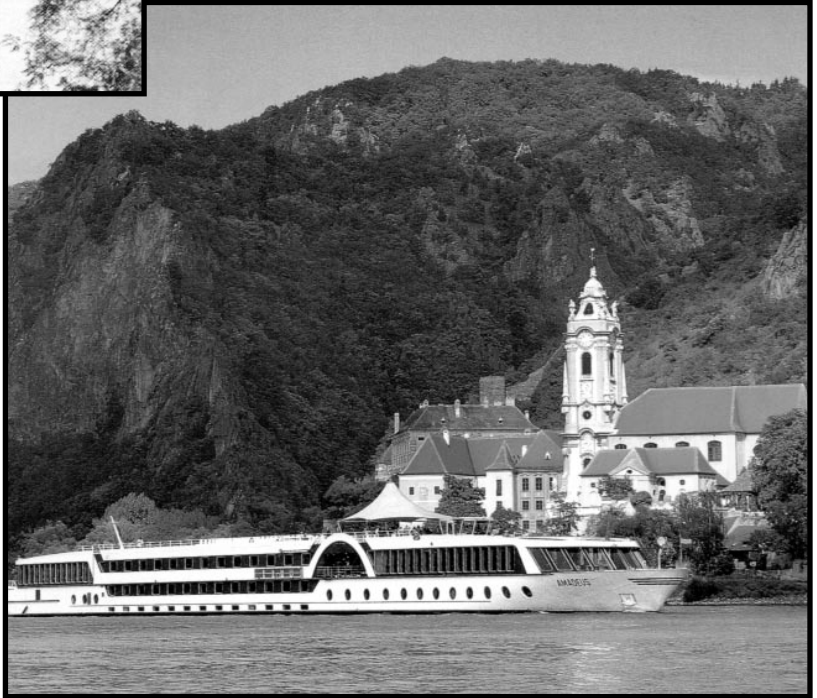
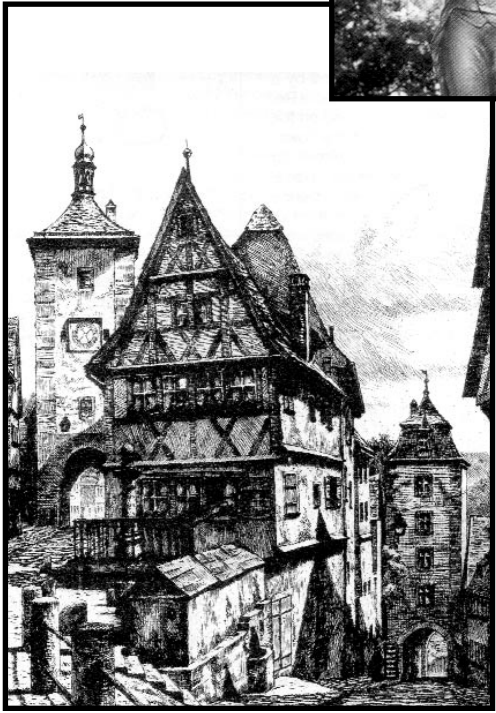

**SPECIAL
TRAVEL
INTERNATIONAL**

3503 East Hastings Street, Vancouver, B.C. V5K 2A8
Tel: 604-291-1332 • Fax: 604-291-1378 • Email: sti@intergate.ca
www.sticanada.com

BUDAPEST – DANUBE CRUISE (Esztergom – Bratislava – Vienna – Wachau – Melk – Linz – Passau) – NUREMBERG – PRAGUE – DRESDEN – BERLIN

Day 01,

Sep 21, Wed: CANADA – BUDAPEST

Departure for Europe

Day 02,

Sep 22, Thu: ARRIVE BUDAPEST

Arrival and transfer to hotel for check in and dinner (D)

Day 03,

Sep 23, Fri: BUDAPEST – EMBARK DANUBE CRUISE

We start with a City Tour with the major sites like the Fishermen's Bastion and St. Stephens Cathedral – then we head to Szentendre, the charming little village north of Budapest – local artisans and typical restaurants line the main square – return to Budapest and embark on the MS AMADEUS CLASSIC – after welcome drinks – dinner – departure upstream later in the evening (B)

Day 04,

Sep 24, Sat: ESZTERGOM – BRATISLAVA

Today we arrive in Esztergom there we tour the Cathedral which is a small scale replica of St. Peter's in Rome, most Hungarian Kings were crowned here and Cardinal Mindzenty worked here – we then continue on to Bratislava, the capital of Slovakia – after a tour of the town we have return aboard ship for dinner

Day 05,

Sep 25, Sun: VIENNA – WACHAU VALLEY

All day in Vienna – with a city tour including the famous sites like the Ringstrasse with its royal buildings, Hundertwasserhaus – and afternoon either at leisure in the city or visit to Schoenbrunn Palace – return to the ship and departure upstream

Day 06,

Sep 26, Mon: WACHAU – MELK – LINZ

Morning arrival in the Wachau Valley, famous for its vineyards and castles – upon arrival in Melk tour of Austria's most famous Benedictine monastery with its art treasures and unique library – continue upstream later this afternoon – farewell dinner this evening

Day 07,

Sep 27, Tue: PASSAU – NUREMBERG

This morning we leave the ship and visit Passau and enjoy an organ concert in the wonderful cathedral – then we travel via Regensburg, famous for its Roman past, on to Nuremberg for overnight and dinner (D)

Day 08,

Sep 28, Wed: NUREMBERG - WUERZBURG – ROTHENBURG – NUREMBERG

Travel to Wuerzburg and City Tour with the beautiful Bishop's residence – then we drive to Germany's best preserved medieval city : Rothenburg – we have time for lunch there and a brief city tour, exploring the historic buildings within the walled city – in the later afternoon we return to Nuremberg in time for dinner (B,D)

Day 09,

Sep 29, Thu: NUREMBERG – PRAGUE

Morning visit of Nuremberg with a walk through the city and then departure for the Prague, the capital of the Czech Republic – check in and dinner (B,D)

Day 10,

Sep 30, Fri: PRAGUE

City Tour of Prague, the "Golden City" including the castle and the historic Inner City with St. Vitus Cathedral and Wenceslas Square – this afternoon you have a bit of time to explore on your own or do some shopping for the famous Czech Crystal before dinner (B,D)



3503 East Hastings Street, Vancouver, B.C. V5K 2A8
Tel: 604-291-1332 • Fax: 604-291-1378 • Email: sti@intergate.ca
www.sticanada.com

Day 11,

Oct 01, Sat: PRAGUE – DRESDEN – BERLIN

Today we visit Dresden, the capital of Saxony; we see the Zwinger Palace and the Semper Opera house before traveling on to Berlin (B,D)

Day 12,

Oct 02, Sun: BERLIN

City Tour with all the main sites from Brandenburg Gate to Reichstag and Checkpoint Charlie etc – enjoy the afternoon in this cosmopolitan city, stroll down the Kurfuerstendamm and do your last shopping before dinner (B,D)

Day 13,

Oct 03, Mon: BERLIN – CANADA

Transfer to the airport for the flight home (B)

Included:

- Air fare Canada – Budapest, Berlin – Canada
- Private bus for all transfers, touring etc prior to cruise and after cruise
- English speaking guide for pre and post tour and excursions aboard ship
- Entrances for all sites visited according to the itinerary
- Accommodation in superior tourist class hotels in Budapest (1) Nuremberg (2), Prague(2), Berlin (2), portorage at hotels
- Breakfasts (B) and dinners (D) during travel “on land” pre and post cruise
- 4 nights/5 days aboard the comfortable MS Amadeus Classic
- All meals aboard (breakfast, lunch, afternoon tea, dinner, late night snack)
- Entertainment aboard
- Port and harbor taxes
- All tips for staff on the ship as well as for guides and drivers pre and post tour
- All excursions aboard the ship
- Taxes and service charges

Not Included:

- Departure taxes
- Insurance
- Lunches on pre and post tour

DECKS:	Haydn	Strauss	Mozart	Suite
From Toronto/Montreal	\$ 3790	\$ 3990	\$ 4190	\$ 4690
From Ottawa	\$ 3890	\$ 4090	\$ 4290	\$ 4790
From Vancouver	\$ 3990	\$ 4190	\$ 4390	\$ 4890
From Calgary/Edmonton/ Saskatoon/Regina/Winnipeg/ Halifax	\$ 4090	\$ 4290	\$ 4490	\$ 4990
single supplement	\$ 800	\$ 900	\$ 1000	\$ 1200



3503 East Hastings Street, Vancouver, B.C. V5K 2A8
 Tel: 604-291-1332 • Fax: 604-291-1378 • Email: sti@intergate.ca
 www.sticanada.com

INSURANCE PREMIUMS

CAPITALS OF CENTRAL EUROPE & DANUBE RIVER CRUISE

September 21 – October 03, 2005 (13 days)

The following are the main areas of coverage - for the full details (and we advise you to read them carefully) refer to the brochure that you will receive after booking.

The KEY POINTS in regards to insurance: that you are in good health. Please note that PRE EXISTING CONDITIONS are not covered. Do check with us if you have any questions in regards to these points!

The following 2 are the packages we offer for this particular trip – if you have any questions ... feel free to call us.

THE ALL INCLUSIVE PACKAGE

RATE PER PERSON:	TO AGE 60	61 – 65	66 – 70	71 - 76	77 +	.
Capitals of C.Europe & Danube Cruise	\$ 174	\$ 194	\$ 225	\$ 309	\$ 385	.

The following are part of the ALL INCLUSIVE PACKAGE offered:

- * CANCELLATION AND INTERRUPTION
- * EMERGENCY MEDICAL (\$2 Million limit)
- * FLIGHT ACCIDENT
- * TRAVEL ACCIDENT
- * BAGGAGE & PERSONAL EFFECTS

If you wish you can also choose the CANCELLATION AND INTERRUPTION insurance alone – that plan is suitable if you have sufficient medical coverage already! (the rates apply to any trip length)

CANCELLATION & INTERRUPTION INSURANCE

RATE PER PERSON:	TO AGE 70	71 +	.
Capitals of C.Europe & Danube Cruise	\$ 232	\$ 248	.

Note: Insurance rates are valid at time of printing and subject to change

SPECIAL TRAVEL INTERNATIONAL

3503 East Hastings Street, Vancouver, BC V5K 2A8 Canada

ph: 604 – 291 1332 fax: 604 – 291 1378

MS AMADEUS CLASSIC

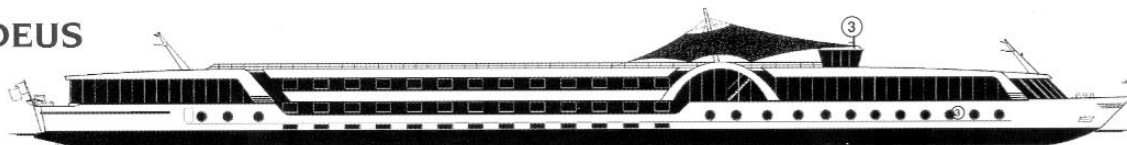

SUN-DECK

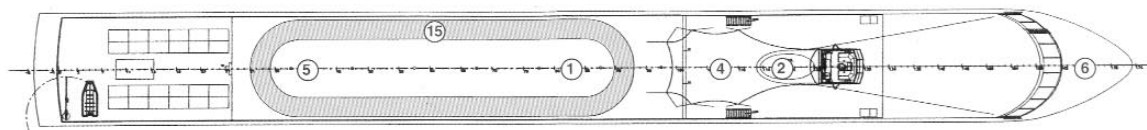

MOZART-DECK

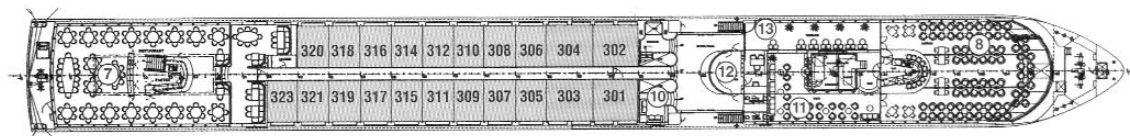

STRAUSS-DECK

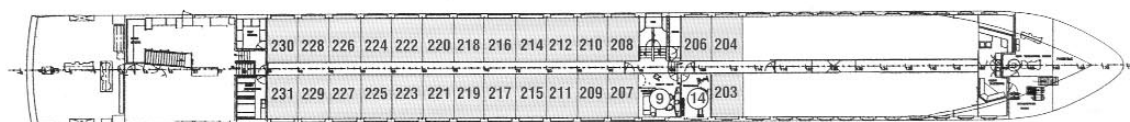

HAYDN-DECK

- A-1 - Mozart-Deck
- B-1 - Strauss-Deck
- C-1 - Haydn-Deck
- APT - Mozart-Deck

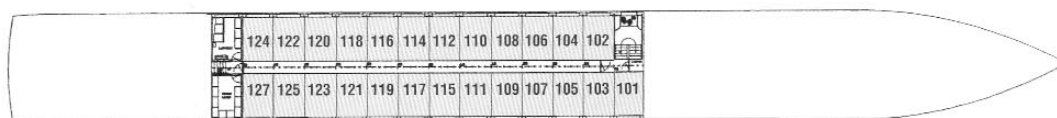

DECKPLAN:

1 Sun-Deck with deck chairs - 2 Fun pool - 3 Navigating bridge - 4 Lido bar - 5 Game of chess - 6 On-board camera - 7 Restaurant
8 Panorama bar - 9 Hairdresser - 10 Board Shop - 11 Amadeus Club - 12 Reception - 13 Hospitality Desk - 14 Fitness - 15 Walking Track

CABIN CATEGORIES:

The 69 passenger cabins and 4 suites are on the outside and spread over 3 decks (named after Mozart, Strauss and Haydn) and are very generously planned (cabins 15 m² and suites 22m²). The tastefully furnished cabins are equipped with shower, WC, air-conditioning, direct-dial telephone and colour TV with an information and video channel in addition to satellite programmes. There is the option of having the two beds spaced apart. The size and furnishings of the cabins are identical on all three decks. The cabins on the Mozart and Strauss deck have a large panorama window (cabins 203-206 have round windows), while the windows on the Haydn deck are somewhat smaller. E-mail service available on board.

TECHNICAL DATA:

Built:	2001
Draught:	1,30 m
Height above water:	5,85 m
Length:	110 m
Breadth:	11,40 m
Speed:	25 km/h max.
Tonnage:	1.566 t
Crew members:	app. 40
Cabins:	69 & 4 suites

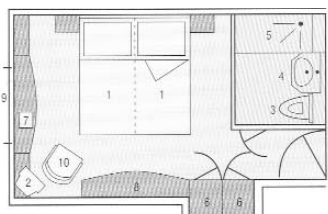

CABIN (15m²):
1-Bed 2-Television 3-Toilet
4-Wash basin 5-Shower 6-Cabinet
7-Telephone 8-Writing desk
9-Window 10-Chair

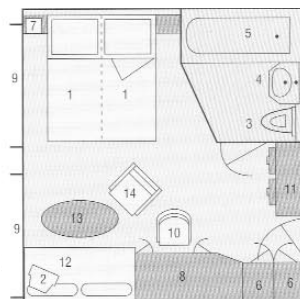

SUITE (22m²):
1-Bed
2-Television
3-Toilet
4-Washbasin
5-Bath-tub
6-Cabinet
7-Telephone
8-Writing-desk
9-Window
10-Chair
11-Minibar
12-Sofa bed
13-Table
14-Chair



m/s **Amadeus**
Classic



The AMADEUS CLASSIC was designed and built in 2001 in the famous Dutch shipyard, De Hoop. With its stylish lines, facilities matching up to the highest standards, and state-of-the-art technology, it ranks among the most handsome ships plying Europe's inland waterways. All you have to do on board is relax and enjoy its 5-star comforts, which ensure your river cruise becomes a unique and memorable experience. An elegant white awning crowns our extensive sun deck. Enjoy the passing scenery there while playing a game of chess or sunbathing.

On the AMADEUS CLASSIC the spacious Panorama restaurant, which can seat all the passengers, is on the Mozart deck, and you can enjoy a wonderful view of the landscape floating by through its panoramic windows. Mealtimes there are memorable.

The Panorama bar is not only the ideal spot to absorb the daytime pleasures of a cruise on Europe's most beautiful waterways. You can finish off the evenings of the cruise there, listening to lively dance music or special events.

The Amadeus Club, with its comfortable leather sofas, has long been established as somewhere to withdraw to read undisturbed, or to enjoy animated conversation.

Additional facilities, such as the hairdresser, fitness room, ship's shop or the comfortable ship's library will contribute to your feeling particularly at ease aboard the AMADEUS CLASSIC.



